



CEDAR LODGE ROOM ASSIGNMENTS

Group Name: _____

This sheet is to assist you in placing your retreaters. Please read the details below, complete the necessary information, enter your group name and return this form to the address below seven days prior to your arrival.

- Bedding and towels (pool towels are not provided) are provided for rental groups ONLY unless specified otherwise by the Bookings Coordinator. **PLEASE fax or email this form with the number of people in each room so that we can prepare your linens prior to your arrival.**
- **We do not provide cribs or playpens.**
- If special arrangement are required for bedwetting concerns, please place a star next to their name so that we can have the appropriate bedding available.
- Keys for rooms are available on request. A fee of \$10.00 will be charged for each key that is not returned.
- Additional mattresses can be provided for extra people in each room. Please indicate below if this is required.
- Room 116 *queen suite is only available will FULL Cedar Lodge booking or upon request.

ROOM 101 _____ _____ _____ _____ 4 single beds	ROOM 102 _____ _____ _____ _____ 4 single beds	ROOM 103 _____ _____ _____ _____ 4 single beds	ROOM 104 _____ _____ _____ _____ 4 single beds
ROOM 105 _____ _____ _____ _____ 4 single beds	ROOM 106 _____ _____ _____ _____ 4 single beds	ROOM 107 _____ _____ _____ _____ 4 single beds	ROOM 108 _____ _____ _____ _____ 4 single beds
ROOM 109 _____ _____ _____ _____ 4 single beds	ROOM 110 _____ _____ _____ _____ 3 single beds	ROOM 111 _____ _____ _____ _____ 4 single beds	ROOM 112 _____ _____ _____ _____ 3 single beds
ROOM 113 _____ _____ _____ _____ 4 single beds	ROOM 114 _____ _____ _____ _____ 3 single beds	ROOM 115 _____ _____ _____ _____ 3 single beds	ROOM 116 *queen suite* _____ _____ _____ 1 queen bed

see over for further details

Return to: Camp Arnes Box 28009 RPO North Kildonan, Winnipeg, MB R2G 4E9

CAMP ARNES CEDAR LODGE FLOOR PLAN

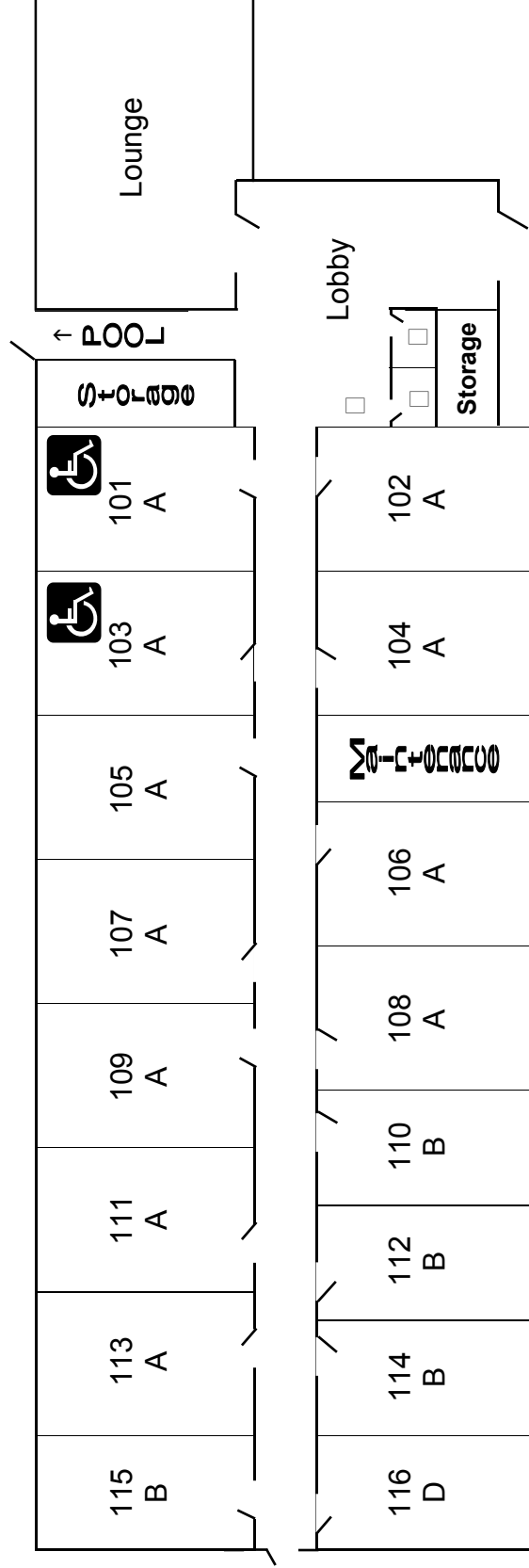

- "A" rooms contain 4 beds and a washroom (bathtub/shower). Maximum occupancy is 6 (4 beds/2 extra mattresses).
- "B" rooms contain 3 beds and a washroom (shower only). Maximum occupancy is 4 (3 beds/1 extra mattress).
- "C" room contains 3 beds and a washroom (bathtub/shower). Maximum occupancy is 6 (3beds/3 extra mattresses).
- "D" room contains 1 queen bed and a washroom (shower only). Maximum occupancy is 3 (1 bed/1 extra mattress).

See over for further details