

# Camp Arnes

## Poplar Grove Floor Plan

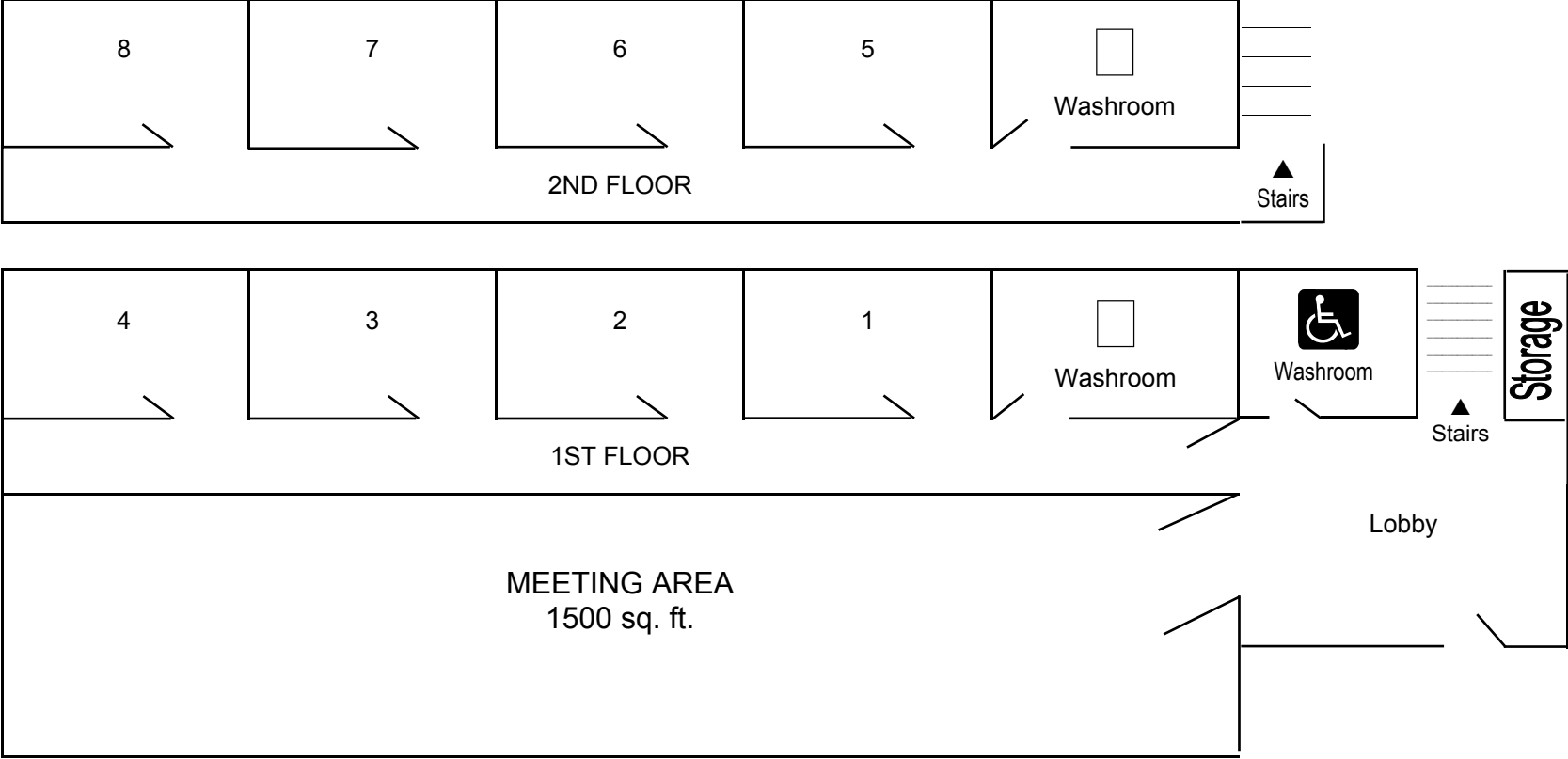

See over for further details ↗

# POPLAR GROVE

**This sheet is to assist you in placing your retreaters and is for your use only.**

Eight rooms - four on the upper level and four on the main floor. Each room contains four bunk beds. Full washroom facilities are on each floor (men's on the main and women's on the upper floor). Wheel-chair accessible washroom off the lobby. Linens are not provided.

## Main Floor

Room 1	Room 2	Room 3	Room 4
1.			
2.			
3.			
4.			
5.			
6.			
7.			
8.			

## Upper Level

Room 5	Room 6	Room 7	Room 8
1.			
2.			
3.			
4.			
5.			
6.			
7.			
8.			

see over for further details ↗