

# **MUSIC CAMP BROCHURE 2022**

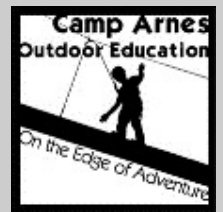

# Rates & General Information

## Music Camp Package

- Host
- Accommodations
- Meals and evening snacks
- Janitorial services
- Pool time (4 lifeguard hours included)
- Hayride (25/ trip)
- Recreational Equipment
- Rehearsal areas
- 1 teacher free for every 25 people in full-time attendance

Fee Per Person	Students	Teachers <i>(if not free)</i>
2 Days / 1 Night	\$114.00	\$114.00
3 Days / 2 Nights	\$172.00	\$161.00
<i>Plus G.S.T</i>		

• Timpani 24" or 26" or 29" (one of each)	• Electric Piano (three)
• Bass Drum (one)	• Conductor Style Music Stands (50)
• 300 Armless Chairs	



### Optional Services and Resources

Lifeguard	\$50.00 / hour
Camp Arnes Staffed Activities	\$50.00 / activity class*

### Additional Information

#### School is required to:

- Provide a supervisor to student ratio of 1:8 while on site, as recommended by the Youth Safe Manitoba, and as required by camps who are accredited with the Manitoba Camping Association.
- Provide a minimum of 1 supervisor for each activity class.
- Provide basic first aid supplies and take responsibility for all first aid/health concerns.
- Clear tables after meals, keep activity areas tidy & clear of litter and clean sleeping areas before departure.

*Please note, Camp Arnes staff are available only as instructors for your camp activities. Schools must provide all supervisory personnel.*

#### June Booking Policy:

- Only Outdoor Education, Standard or Deluxe packages are available.

#### Discount Seasons:

- **10% discount** is applied to the package rate for bookings taken during the following periods:
  - the 2nd Monday in March through the 4th Friday in April.
  - the 1st Monday in November through the end of December.

#### \*Activity Class:

- Maximum 1½ hour period for up to 12 students.

**All fees are subject to GST and are subject to change without notice**

# Activity Options

## Program Activities

Camp Arnes has activities for year-round adventure that are available to enrich your Music Camp experience. Teach your own classes or select from those taught by our Resource Staff (CA). Put together an exciting program that suits you and your students.

### Year-Round

#### Cooperative Games

These activities inspire group cooperation and build and strengthen group dynamics. Some activities include shooshing, human knot, group juggling etc. **CA or School**

#### Initiative Tasks

Students will be asked to solve problems through team work. Promotes the building of self esteem, group cooperation and leadership skills. **CA or School**

#### Nature Hike

A guided nature hike that allows students to observe and become acclimatized to the natural environment. Students will encounter many types of plants and signs of wildlife. **CA or School**

#### Fire Building & Bannock

Students use natural materials to build a fire and have an opportunity to cook bannock. **CA only**

#### Orienteering

Introduces the students to the use of a map to help them travel in unfamiliar territory. They will gain an understanding of accurate transferring of information (compass work optional). **CA or School**

#### Instincts for Survival

A simulation of life in the Manitoba woods. Students take on the role of a herbivore, omnivore or carnivore and their goal is to collect food and water while avoiding predators. This is an excellent large group activity. **CA or School**

### Winter

#### Cross Country Skiing

Students will learn about the equipment, spend some time on skiing technique, then follow up with time spent on the ski trails. **CA or School**

#### Ice Fishing

During this class students will experience ice fishing techniques modeled after the pioneer Icelandic fishermen. Time is taken for filleting and species identification. **CA only**

#### Snowshoeing

Students will learn the techniques required to master this skill. Then it's off to explore the bush. **CA or School**

#### Quinzee Building

Allows students the opportunity to build, experience and study the construction of a Quinzee. **CA or School**

### Spring & Fall

#### Emergency Shelter Building

Students learn to provide a quick respite from the cold, wind or other inclement weather conditions. **CA or School**

#### Zip Line

Students are will tackle this 280 foot adventure from the top of a 37ft platform. The class challenges students to step out of their comfort zone. **CA only**

#### Archery

Students are introduced to the basics of archery. The class challenges students to develop and master personal technique.

#### CA only Climbing Wall

Enjoy the excitement and challenge of our 32 foot wall with instruction from our skilled resource staff. **CA only**

#### Giant Swing

Get a new perspective from the top of our Giant Swing! Just like a playground swing, except on a bigger scale, and a lake view that will take your breath away. **CA only**

#### High Ropes Course

Students are challenged to go to new heights and experience both individual and groups challenges. **CA only**

## Other Activity Options

#### Candace Derksen Memorial Pool

After a full day of activities, teachers and students can enjoy a swim in our indoor heated pool (30 X 50 ft.) or relax in our whirlpool spa. Available for evening programming. **CA only**

#### Hayrides

Enjoy a leisurely tractor pulled wagon ride through our scenic trails. Available for evening/daytime programming. 25 people per trip **CA only**

#### Recreational Equipment

Available for evening programming and free time activities. **School only**

**Year Round:** Ping Pong ♦ Shooshing Boards ♦ Play Structure ♦ Human Foosball

**For Rent:** (Year Round) Sumo Suits

**Winter:** Broomball ♦ Skating ♦ Toboggan Run

**Spring & Fall:** Beach Volleyball ♦ Shuffleboard ♦ Tether Ball ♦ Basketball ♦ Pool Ball ♦ Frolf

# Accommodations

## Poplar Grove

Enjoy this modern facility with meeting area. Contains 8 rooms - 4 on the upper level and 4 on the main floor. Each room contains 4 bunkbeds. Full washroom facilities are on each floor (guys on the main floor and girls on the upper floor). **Capacity 64 people.**

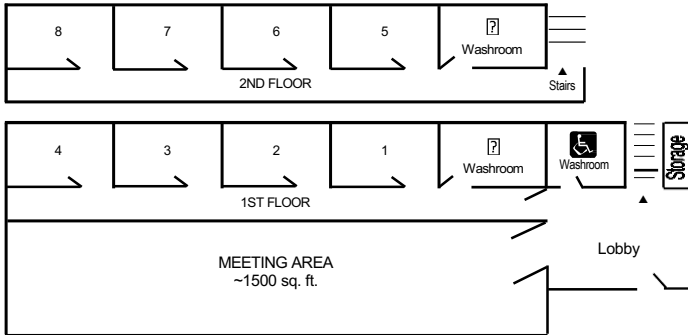

## The Chalets

Three chalets, two units each. Each unit contains a private room with double/single bed. The main area has 4 sets of bunkbeds. Additional sleeping for 4-6 (on mattresses) available in mezzanine. Full 3 piece bath in each unit. **Capacity 15 people per unit.**

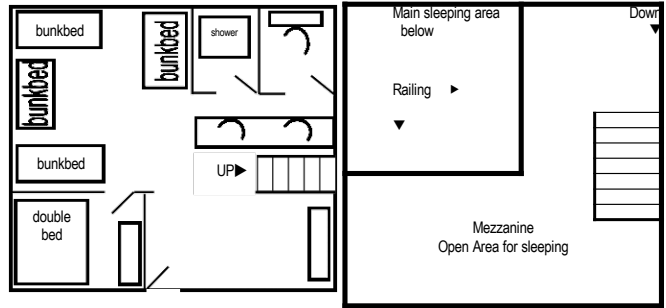

## Cabins

10 heated cabins with bunkbeds. Number of bunkbeds vary with cabin. Heated washrooms with 3 piece bath in cabin vicinity. **Total cabin capacity approximately 102.**

### Meeting Areas

Lighthouse ~ 1800	sq.	ft.
Poplar Grove Lounge ~ 1500	sq.	ft.
Honeycomb ~ 1200	sq.	ft.
Shady Pine Lounge ~ 850	sq.	ft.
Studio ~ 1025	sq.	ft.
Flowing Wall	~ 800 sq. ft.	ft.
Wild Rose	~ 390 sq. ft.	ft.

## Location

Camp Arnes is a Christian non-profit camp, outdoor education and retreat centre situated on the shore of Lake Winnipeg on 320 acres of wooded forest, and meadows. Our purpose is to further God's kingdom through relationships and adventure in creation. Our smoke free facilities include a variety of comfortable accommodations, spacious meeting rooms, and a dining hall which provides seating for up to 275 people.

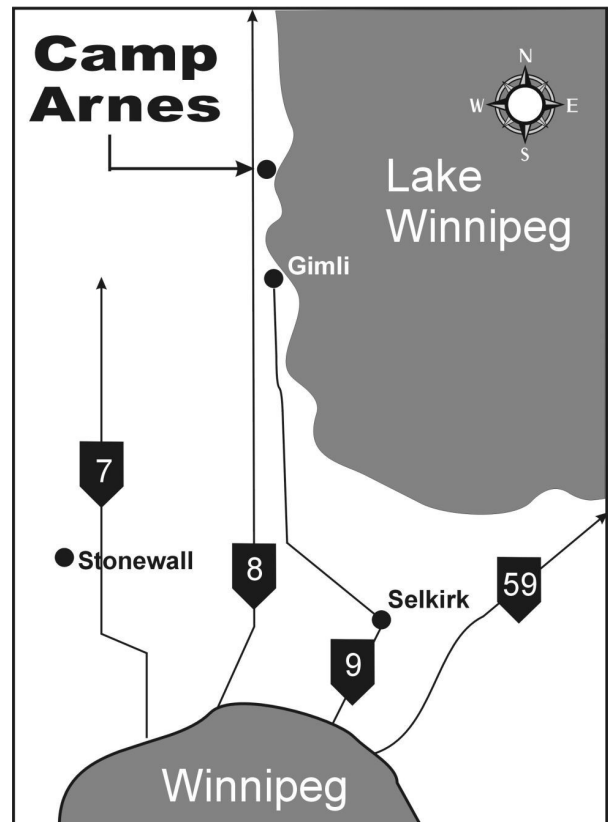

**For more information  
or to discuss a booking contact:**

**Booking Coordinator**

Box 28009 RPO NK  
Winnipeg, MB R2G 4E9

Phone: 204-338-4647

[bookings@camparnes.com](mailto:bookings@camparnes.com)

*A completed application form and deposit  
is required to confirm a booking.*

Accredited with



Member of  
Christian Camping International



Check out our Website

[www.camparnes.com](http://www.camparnes.com)